



GREENFIELD

P2P-179/292: MSI Collaborative Planned order/Commit Gap Planning Report

13 July 2018

P2P-179/292: Planned order/Commit Gap Planning Report



☐ Deployed in Production 14 July 2018

- ❖ A report is now available for users (Buyer / Supplier) to query the Collaborative Planning : Plan Order vs Supply Commit Gaps.
- ❖ Report will detail week over week Cumulative Gaps.
- ❖ Report Horizon: 26 weeks.
- ❖ Supplier users can now easily use this report to identify the items which are not meeting MSI's required Plan Orders.



P2P-179/292: Planned order/Commit Gap Planning Report

□ Running the report

- ❖ CP Home Page - > Supply Chain Collaboration Planner>View and Run Requests
- ❖ In the following page - > Submit Request



- ❖ Select Program Name: **MSI Collaborative Planned order/Commit Gap Planning Report**. Hit “Continue” -> “Submit” to proceed.

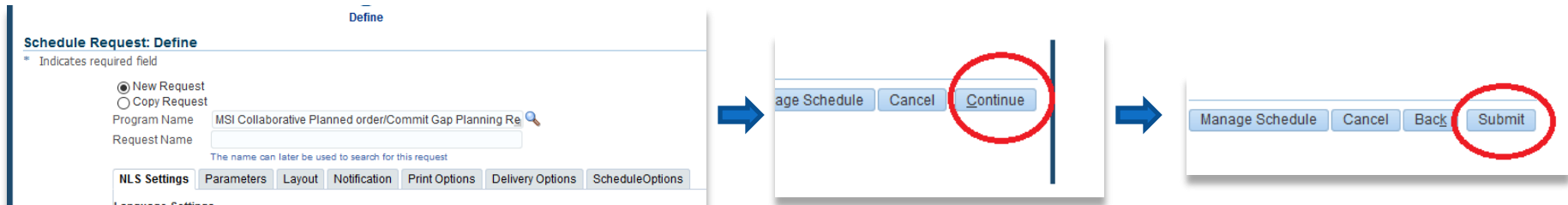



P2P-179/292: Planned order/Commit Gap Planning Report

❖ You will get a request ID once Program has been submitted

Information

Your request for MSI Collaborative Planned order/Commit Gap Planning Report has been scheduled.
The Request ID is 822114

OK

❖ Report is ready once its been Completed with status Normal.

Requests

Request Query Type: All My Requests

Requests Summary Table

|

Request ID ^	Name ^	Phase ^	Status	Scheduled Date ^	Details	Output ^
822114	MSI Collaborative Planned order/Commit Gap Planning Report	Completed	Normal	12-Jul-2018 08:44:50		

❖ Select Output to open up the Report. It will open up in Microsoft Excel



P2P-179/292: Planned order/Commit Gap Planning Report

□ Reading the report



A	B	C	D	E	F	G	H	I	J	K	L	M	N	O	P	Q	R	S	T
CP Version	Item	Supplier	Supplier Site	Org	Plan Order	Supply Commit	Gap	Plan Order	Supply Co	Gap	Cumulative	Plan Order	Supply Co	Gap	Cumulative	Plan Order	Supply Co	Gap	Cumulative
					09-JUL-2018	09-JUL-2018	09-JUL-2018	16-JUL-2018	16-JUL-2018	16-JUL-2018	16-JUL-2018	23-JUL-2018	23-JUL-2018	23-JUL-2018	23-JUL-2018	30-JUL-2018	30-JUL-2018	30-JUL-2018	30-JUL-2018
06-JUL-18	85012033	Test_Supp	001	PRD:MY2	0	0	0	0	0	0	0	0	0	0	0	0	0	0	0
06-JUL-18	85012065	Test_Supp	001	PRD:MY2	0	100	100	0	100	100	200	0	100	100	300	0	0	0	300
06-JUL-18	8505241U	Test_Supp	001	PRD:US2	0	0	0	0	0	0	0	0	0	0	0	0	0	0	0
06-JUL-18	8505241U	Test_Supp	001	PRD:US2	0	0	0	0	0	0	0	300	0	-300	-300	0	0	0	-300
06-JUL-18	8505241U	Test_Supp	001	PRD:MY2	0	0	0	0	0	0	0	0	0	0	0	0	0	0	0
06-JUL-18	8505241U	Test_Supp	001	PRD:US2	0	0	0	0	0	0	0	0	0	0	0	300	0	-300	-300
06-JUL-18	8505241U	Test_Supp	001	PRD:US2	0	0	0	0	0	0	0	0	0	0	0	0	0	0	0
06-JUL-18	8505518V	Test_Supp	001	PRD:US2	0	0	0	0	0	0	0	0	0	0	0	0	0	0	0
06-JUL-18	8505644V	Test_Supp	001	PRD:US2	0	0	0	0	0	0	0	0	0	0	0	0	0	0	0
06-JUL-18	8505644V	Test_Supp	001	PRD:US2	0	0	0	0	0	0	0	0	0	0	0	0	0	0	0
06-JUL-18	8505644V	Test_Supp	001	PRD:US2	0	0	0	0	0	0	0	0	0	0	0	0	0	0	0
06-JUL-18	8505644V	Test_Supp	001	PRD:US2	0	0	0	0	0	0	0	0	0	0	0	0	0	0	0
06-JUL-18	8505644V	Test_Supp	001	PRD:US2	0	0	0	300	0	-300	-300	0	0	0	-300	0	0	0	-300

****** Suppliers will be measured for Supply Commit Compliance. The total 26 weeks Supply Commits should not be less than the total 26 weeks Plan Orders**